

curtain wall

products

Schüco FW50+.SI | 38

PHI Certified Aluminum Curtain Wall

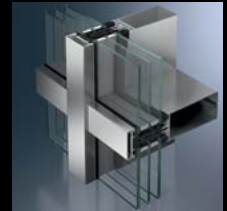

Makrowin MW50 | 39

PH Performance Wood Curtain Wall

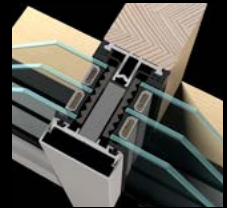

Cambridge, MA Residence

Design: Moskow Linn Architects
MacArthur Construction Co.

Product:

Schüco FW50+.SI Passive House Curtain Wall
Glass: R-10 Triple-Pane, SHGC 0.50

■ ■ EUROPEAN
■ ■ ARCHITECTURAL
■ ■ SUPPLY

FINE WINDOWS FOR ALL SEASONS

Schüco FW50+.SI Curtain Wall

Passive House Certified Aluminum Curtain Wall

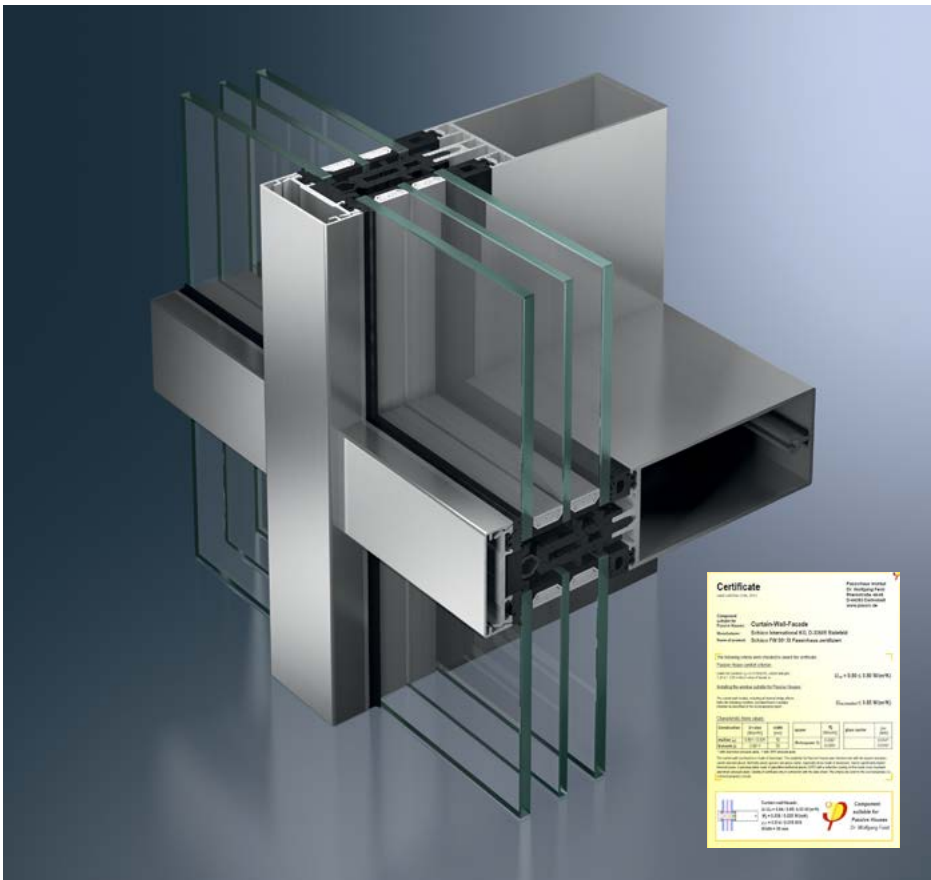

Schüco FW50+.SI with Passive House Certificate

The newly developed FW50+.SI (Super Insulated) version of the aluminum mullion/transom construction is the most efficient curtain wall system in the world.

The isolator design uses super-insulating materials to reduce thermal transfer via the frame. Inward-facing reflective surfaces on the pressure plates also contribute to the outstanding U_f value of up to $0.78 \text{ W}/(\text{m}^2\text{K})$, including the fasteners. The system achieves this value for the Passive House (PH) certified version with a glazing thickness of 48 mm.

As part of Passive House Institute (PHI) certification, the system meets the PH comfort criterion of $U_{cw} \leq 0.80 \text{ W}/(\text{m}^2\text{K})$ and satisfies the PH requirements with outstanding thermal insulation. The PHI calculated and certified the profile in accordance with the latest criteria for certifying façade systems, using triple insulating glazing ($U_g = 0.70 \text{ W}/(\text{m}^2\text{K})$) with a façade module of $1.20 \text{ m} \times 2.50 \text{ m}$. EAS offers the FW50+.SI system with glazing up to $U_g = 0.50 \text{ W}/(\text{m}^2\text{K})$, enabling PH designers to exceed the PHI performance standard and provide their clients with living spaces with more glazing area.

Glass Roofs and Skylights

The FW50+ curtain wall was designed for both vertical wall and overhead glass roof applications. The overhead curtain wall system is specifically designed for horizontal condensation management, snow-load strength and design flexibility. The FW50 mullions are available in depths from 85 mm to 250 mm (3.3 in - 10 in) to satisfy even the most demanding structural loads.



Schüco FW50 glass roof

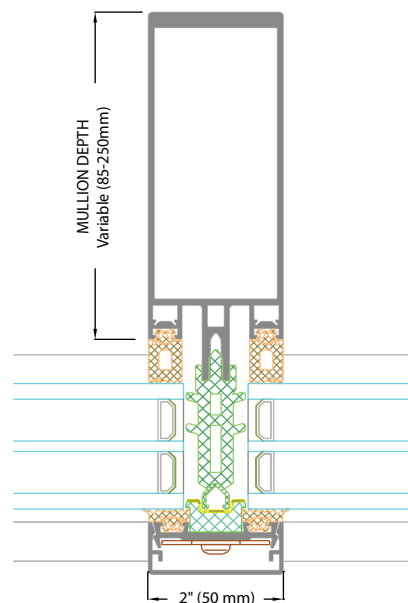

Section detail of FW50+.SI

Parameters	
Frame depth	85 - 250 mm 3.35 - 9.84 in
Frame face width	50 mm 2 in
Thermal insulation U_f	$0.78 \text{ W}/(\text{m}^2\text{K})$ $0.133 \text{ Btu}/(\text{hr}\cdot\text{ft}^2\cdot^\circ\text{F})$

Makrowin MW50 Curtain Wall

High Efficiency Wood/Aluminum Curtain Wall System

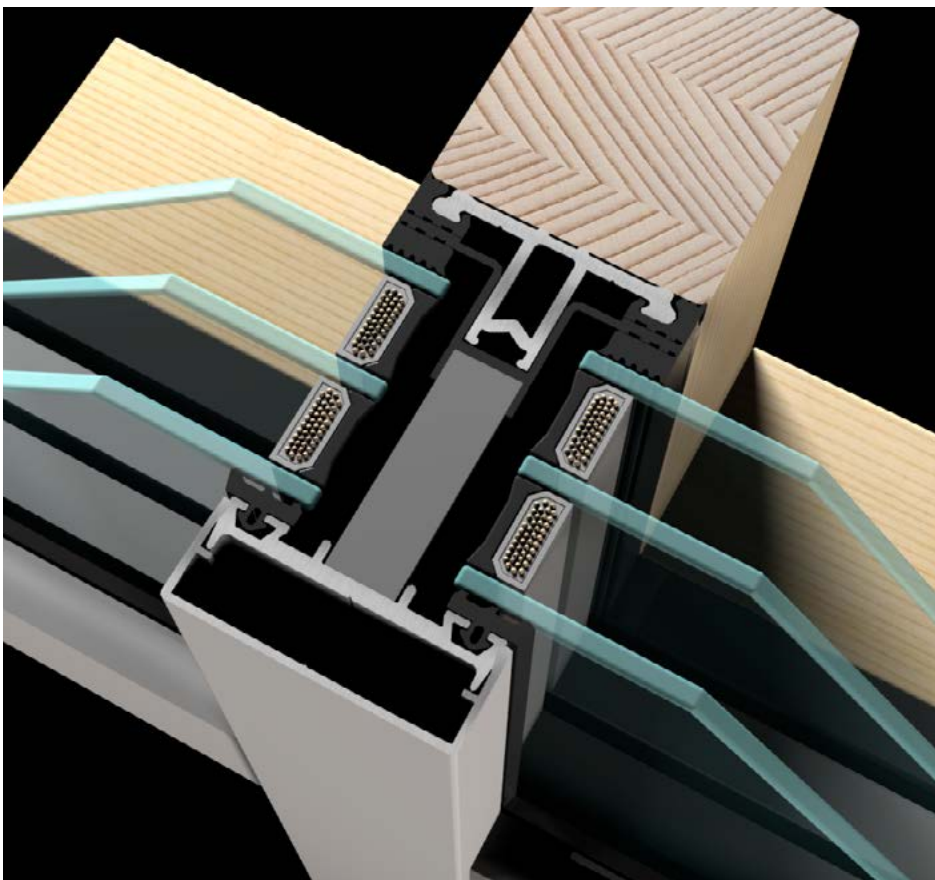

Makrowin MW50 Wood/Aluminum Curtain Wall



MW50 Curtain Wall with Natural Stain Finish

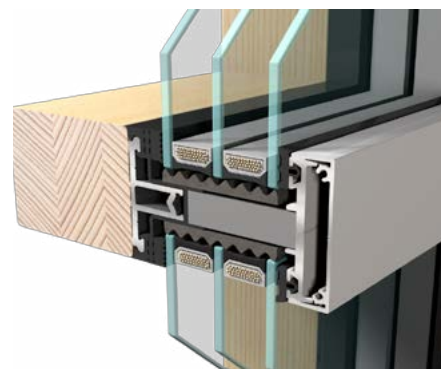

MW50 Horizontal Transom

The MW50 wood curtain wall is an excellent choice for architects who want to create large expanses of floor-to-ceiling glass while maintaining the warm look of natural wood. Handcrafted from multiple layers of top grade solid wood, the curtain wall mullions provide exceptional strength and dimensional stability.

The glazing bar utilizes the best designs inherited from the world of aluminum curtain walls. The isolator design uses super-insulating materials to reduce thermal transfer via the frame and virtually eliminates condensation near wood surfaces.

The MW50 mullions have a face width of 50 mm (2 in) and are available in various depths to satisfy the requirements of differing structural loads.

Glass up to R-14, SHGC=0.62

Partnering with Saint Gobain Glass, we use the most innovative glass substrates in the world. Our triple-pane glass reaches up to R-14 and SHGC=0.62, giving PH designers greater flexibility when modeling projects in PHPP.

Parameters	
Frame depth	85 - 250 mm 3.35 - 9.84 in
Frame face width	50 mm 2 in

EUROPEAN
ARCHITECTURAL
SUPPLY

North American Distributor
of Fine European Windows
M A K R O W I N

SCHÜCO

144 North Road Suite 2500 | Sudbury, MA 01776

2013 Copyright © European Architectural Supply, LLC. All Rights Reserved.
Schüco is a registered trademark of Schüco International KG.
Makrovin is a registered trademark of Makrovin s.r.o.
Photos: Schüco International KG
Photos: Greg Pierru Photography
Design: Chin Communications



fine windows
for all seasons

www.finewindows.com

EUROPEAN ARCHITECTURAL SUPPLY | SUPERVISED DELIVERY | INSTALLATION | TRAINING | SERVICE